

Varenummer: 25220266102
 Beskrivelse: ICME Asynkronmotor M100L B2 2,2KW
 2800 o/m 1x230 V B3/B14 med driftskondensator

Mål

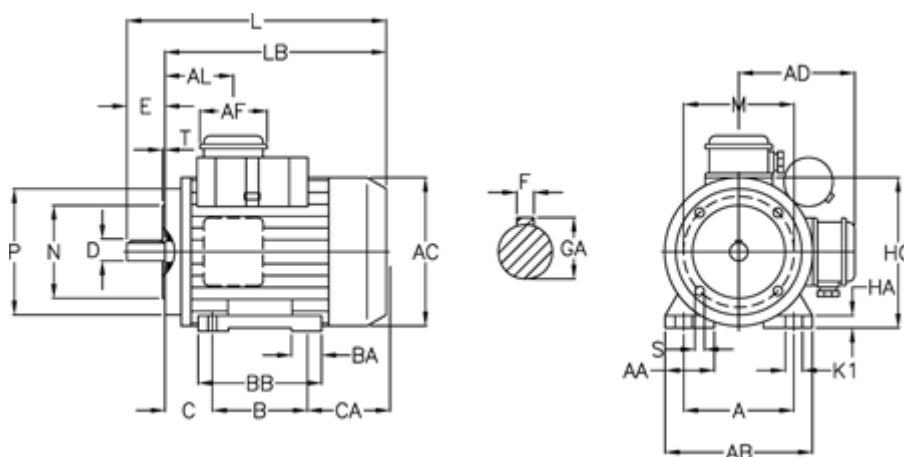

| | | | | |
|----------|-------------|----------|----------|---------|
| A = 160 | BA = 40 | EA = 60 | K = 12 | S = M8 |
| A/F = 84 | BB H7 = 176 | F = 8 | K1 = 20 | T = 3.5 |
| AA = 42 | C = 63 | GA = 31 | L = 366 | |
| AB = 200 | CA = 105 | GD = 7 | LB = 306 | |
| AC = 195 | D = 28 | H = 100 | LC = 429 | |
| AD = 140 | DA = 28 | HA = 14 | M = 130 | |
| AL = 96 | DB = M10 | HC = 200 | N = 110 | |
| B = 140 | E = 60 | HD = 240 | P = 160 | |